

4 HOLES .375" Ø FOR SUSPENDING UNIT
4 TROUS .375" Ø POUR SUSPENDRE UNITÉ

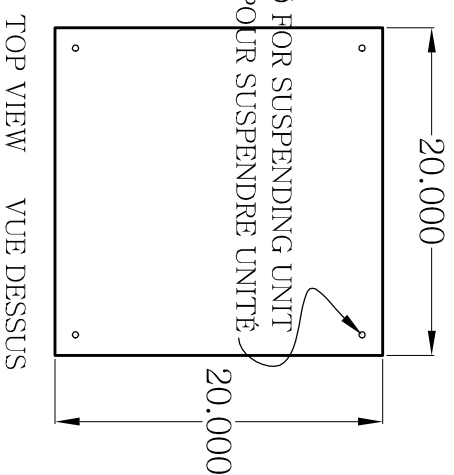

TOP VIEW VUE DESSUS

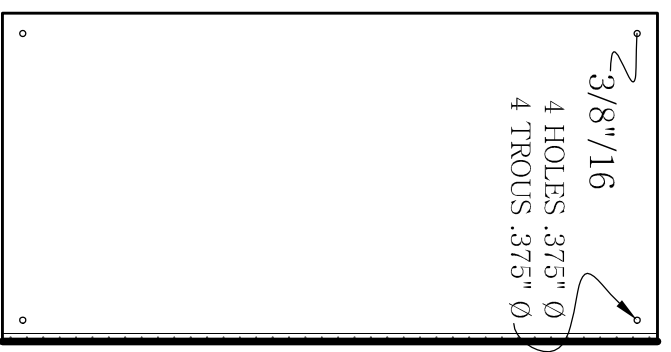

BACK VIEW VUE ARRIERE

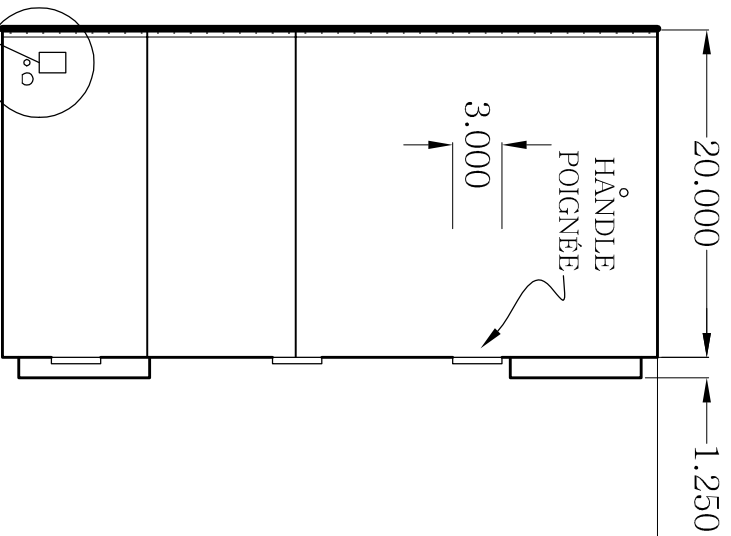

LEFT VIEW VUE GAUCHE

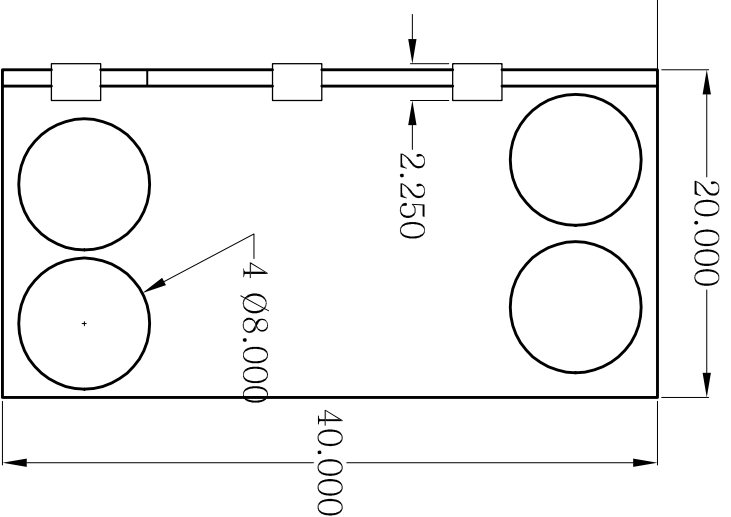

FRONT VIEW VUE AVANT

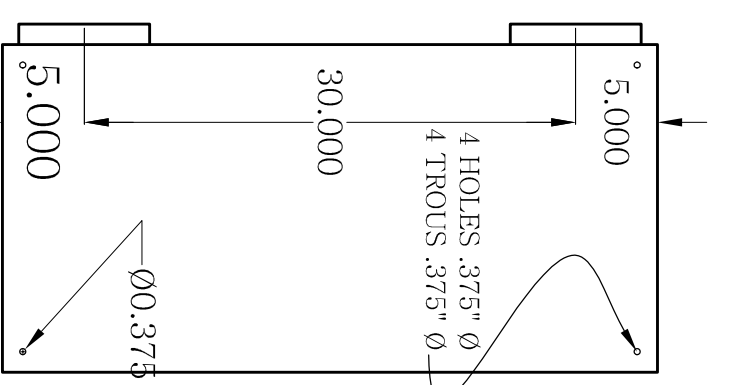

RIGHT VIEW VUE DROITE

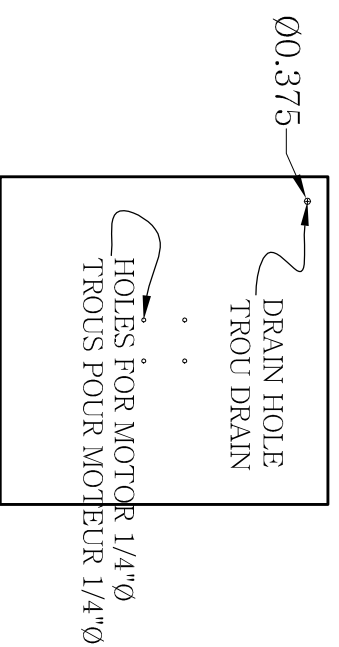
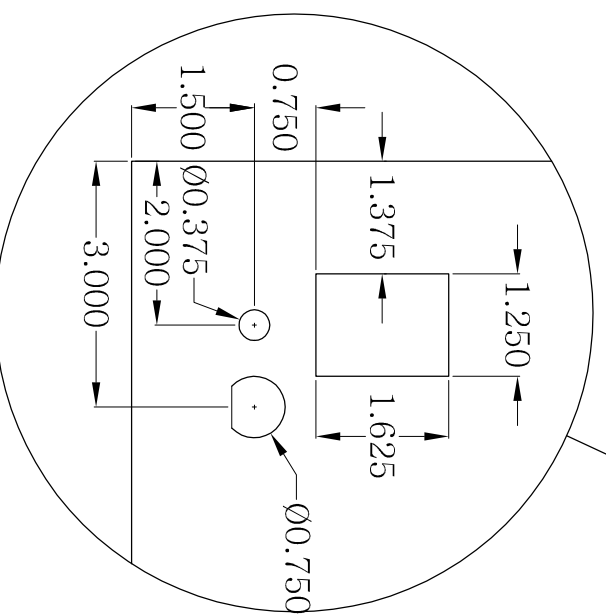

BOTTOM VIEW VUE DESSOUS

SANUVOX TECHNOLOGIES INC.
5757 CAVENDISH, SUITE 411
MONTREAL, (QUÉBEC)
CANADA H4W 2W8
TEL: (514) 382-5823
FAX: (514) 382-6475
TOL FREE: 1-888-SANUVOX
WWW.SANUVOX.COM



NOTES:

L'ENTREPRENEUR SERA TENU DE PRENDRE ET DE VÉRIFIER TOUTES LES DIMENSIONS AU CHANTIER ET D'INFORMER L'INGÉNIEUR DE TOUTTE DIVERGENCE OU OMISSION, AVANT LE DEBUT DE L'INSTALLATION.
THE CONTRACTOR IS OBLIGATED TO VERIFY ALL DIMENSIONS ON THE FIELD AND CONTACT THE ENGINEER OF ALL DIVERGENCE OR OMISSION PRIOR TO INSTALLATION.
LE DESSINATEUR CE DÉGAGE DE TOUTTE RESPONSABILITE. THE DRAFTSMAN DISCLAIM ALL RESPONSABILITY.

REMARQUES:

MATÉRIEL: AL. PEINT
MATERIAL: AL. PAINTED
MESURE: POUCES
MEASURE: INCHES

CLIENT:	SANUVOX
SÉRIE:	S 1000 FX
NUMERO:	
MODEL:	
ÉCHELLE:	1:12
DESIGNÉ PAR:	M.C.
APPROUVÉ PAR:	
VÉRIFIÉ PAR:	
DATE:	MARS 2004
PAGE:	1/1